



Flanged gate valves, designed according to BS 5150
Face to face according to BS 5163: 1986
Standard flange drilling to EN1092-2 (ISO 7005-2)

Use:

For water to max. 70°C

Test:

Hydraulic test to BS EN 1074

Seat: 1.1 x PN

Body: 1.5 x PN

Optional extras:

Hand wheel.

Marking:

DN, PN, casting no. and body material.

Materials

Body	Ductile Iron GGG50
Bonnet	Ductile Iron GGG50
Wedge	Ductile Iron GGG50
	Fully encapsulated with EPDM
Stem Nut	DZR Brass CW602N
Stem	Stainless Steel 2Cr13/AISI420
Gland bushing	Akulon
O-rings	NBR
Gasket	EPDM
Coating	Epoxy coating RAL7011

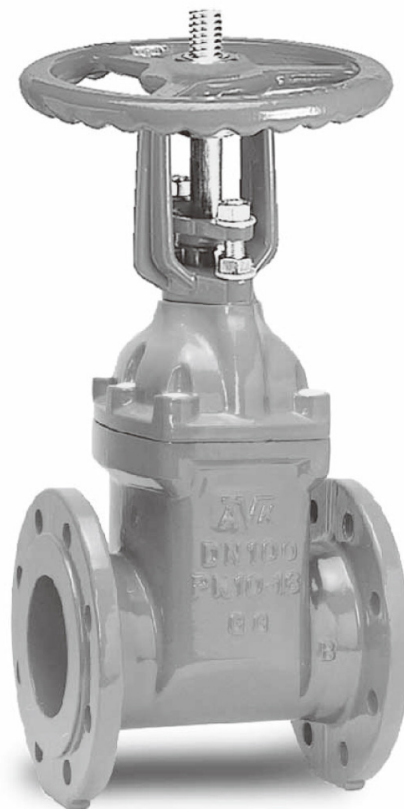

Flanged gate valves, designed according to BS 5150
Face to face according to BS 5163: 1986
Standard flange drilling to EN1092-2 (ISO 7005-2)

Component list

- | | | | | |
|-----------------|------------------|-------------------|--------------------|---------------|
| 1. Body | 6. Stem | 11. Gland bushing | 16. Nut | 21. Handwheel |
| 2. Wedge body | 7. Bonnet Bolt | 12. O-ring | 17. Gland follower | 22. Stem nut |
| 3. Wedge rubber | 8. Bonnet gasket | 13. O-ring | 18. Yoke | |
| 4. Stem nut | 9. Bonnet | 14. Washer | 19. Stud bolt | |
| 5. Pin | 10. Seals | 15. Gland | 20. Washer | |

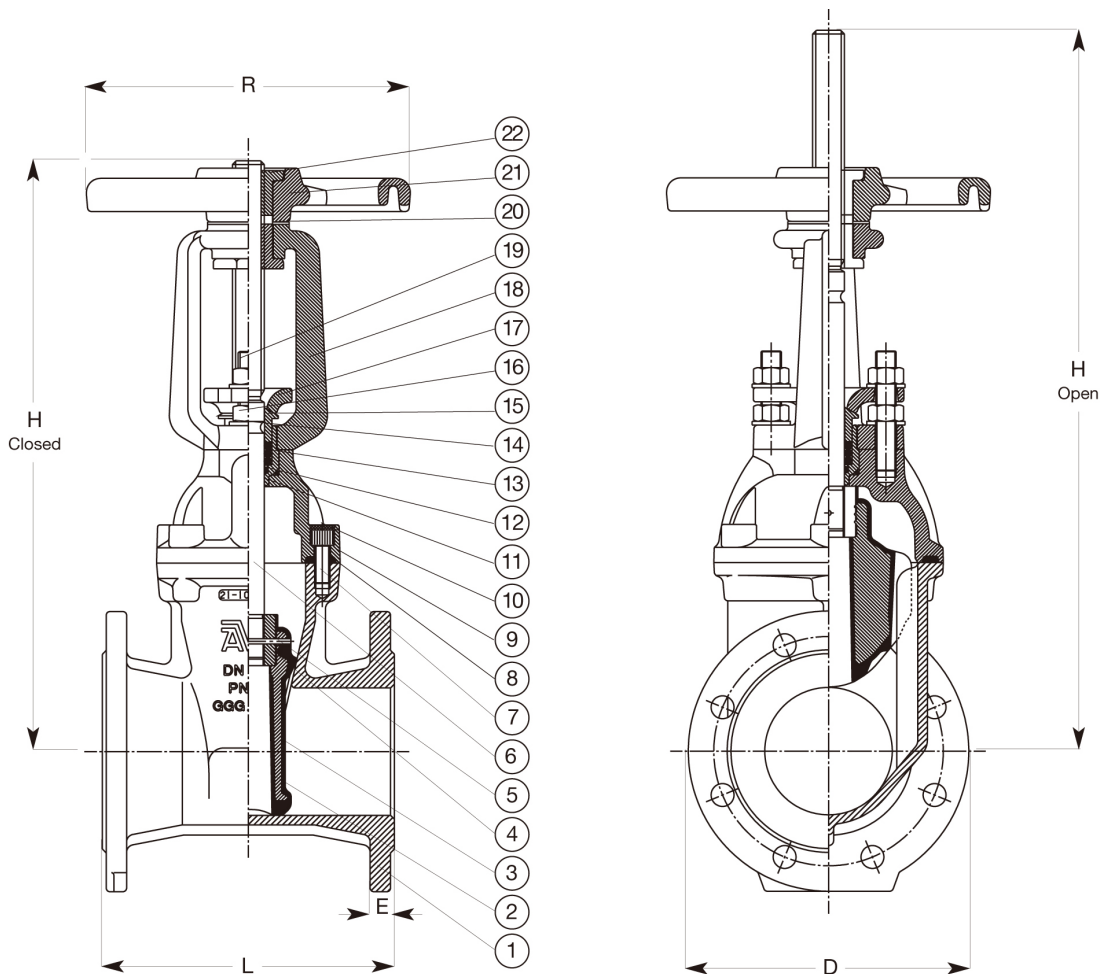

Ref.no.	DN	L mm	Ho mm	Hc mm	R mm	D mm	E mm	Holes	Turns to open	Weight Kgs
21-050-66-0742	50	178	419	368	180	165	19	4	13	19
21-065-66-0742	65	190	453	385	180	185	19	4	17	23
21-080-66-0742	80	203	480	440	180	200	19	8	20	25
21-100-66-0742	100	229	575	475	254	220	23	8	20	39
21-150-66-0742	150	267	783	633	305	285	28	8	30	63
21-200-66-0742	200	292	990	791	356	340	28	8	33	97
21-250-66-0742	250	330	1206	922	432	400	25	12	47	155
21-300-66-0742	300	356	1375	1052	432	455	28	16	46	203
21-400-66-0742	400	406	1800	1365	640	580	32	16	62	305

