



**Swing check valve, designed according to EN1074 part 3
Face to face according to EN 558 table 2 basic series 10
Standard flange drilling to EN 1092-2**

Use:

For water to max. 70°C

Tests:

Hydraulic test to BS EN 12266

Seat: 1.1 x PN

Body: 1.5 x PN

Marking:

DN, PN, casting no. and body material.

Materials

Body	Ductile Iron
Washer	Stainless steel
Nut	Stainless steel
Disc	Carbon steel with EPDM coating
Hinge	Stainless steel AISI 316 DN50-200 Ductile Iron DN250-300
Bonnet gasket	EPDM
O-ring	EPDM
Bonnet	Ductile Iron
Bolt	Stainless steel



Swing check valve, designed according to EN1074 part 3
Face to face according to EN 558 table 2 basic series 10
Standard flange drilling to EN 1092-2

Component list

- | | | | |
|-----------------|------------------|-------------------|----------------|
| 1. Body | 5. Disc | 9. Bushing closed | 13. Bonnet |
| 2. Washer | 6. Hinge | 10. O-ring | 14. Tab washer |
| 3. Nut | 7. Shaft | 11. Washer | 15. Bolt |
| 4. Bushing open | 8. Bonnet gasket | 12. Bolt | 16. Bolt |

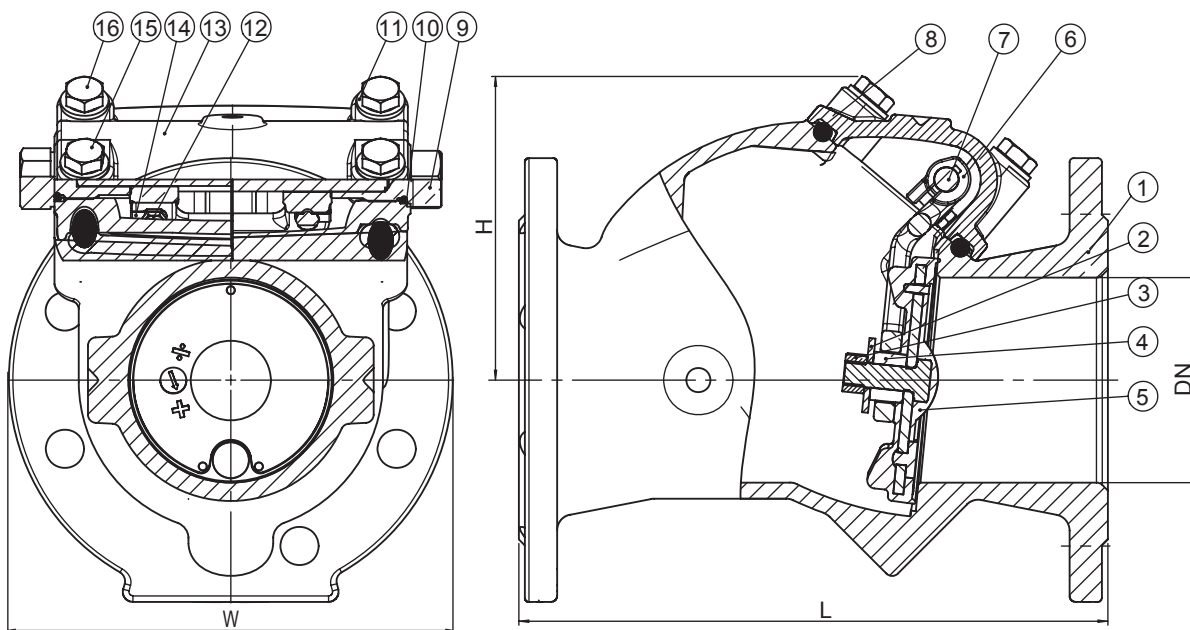

Ref.no.	DN	L mm	H mm	W mm	Weight Kgs
41-050-21-018	50	203	110	190	13
41-065-21-018*	65	240	140	190	17
41-080-21-018	80	241	140	200	20
41-100-21-018	100	292	150	220	26
41-125-21-018*	125	350	195	273	40
41-150-21-018	150	356	195	285	51
41-200-21-018	200	495	230	340	83
41-250-21-018	250	622	270	536	183
41-300-21-018	300	698	300	536	231

*Face to face according to DIN3202 Part-F6

