



**To BS 5351
Flanges and drilling to BS EN 1092-2**

Use:
For water max. 90°C

Tests:
Hydraulic test to BS EN 12266
Seat: 1.1 x PN
Body: 1.5 x PN

Marking:
To BS 5351
Body: ICV logo, DN, PN, casting no.
and body material.

Materials	
Body	Stainless steel AISI 304/316
Seat	PTFE
Ball	Stainless steel AISI 304/316
Stem	Stainless steel AISI 304/316
Lever	Carbon steel

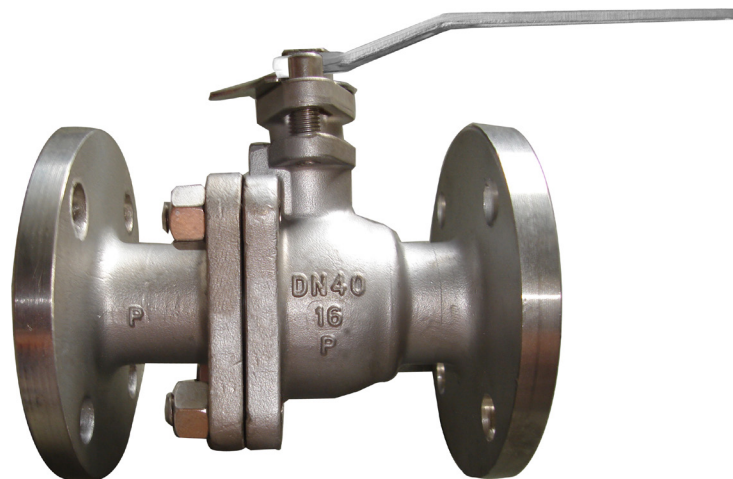

To BS 5351
Flanges and drilling to BS EN 1092-2

Component list

- 1. Body
- 2. Seat
- 3. Ball
- 4. Stem
- 5. Lever

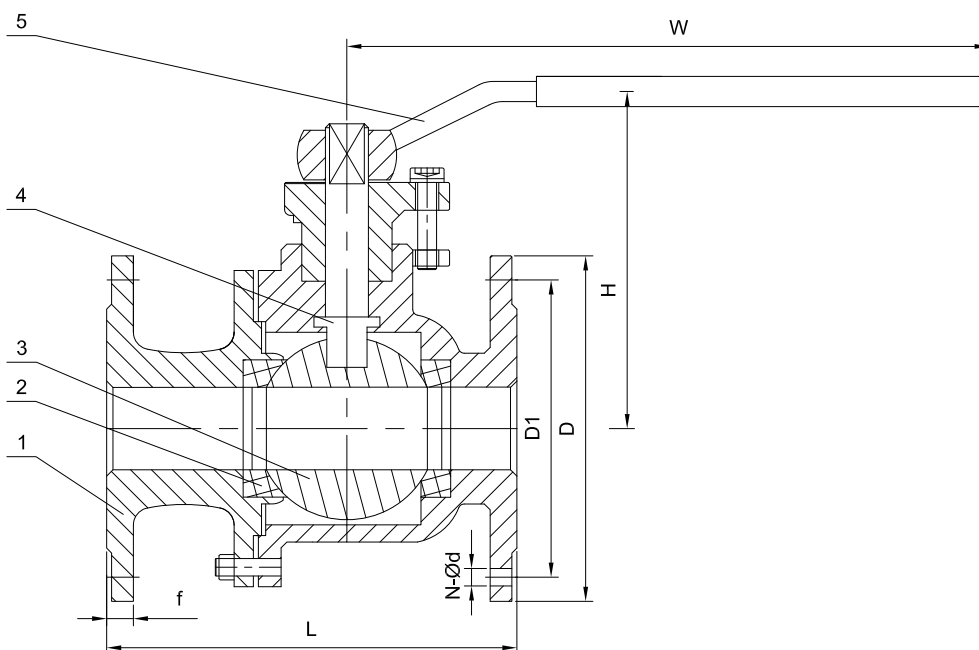

Ref.no.	DN	L		D		D1		H	W	N-Ød		f		Weight	
		mm		mm		mm				mm		mm		Kgs	
				PN16	PN25	PN16	PN25			PN16	PN25	PN16	PN25	PN16	PN25
907080015X0YY	15	130		95		65		65	115	4-Ø14		14		2.4	
907080020X0YY	20	140		105		75		75	130	4-Ø14		14		3	
907080025X0YY	25	150		115		85		85	150	4-Ø14		14		3.9	
907080032X0YY	32	165		140		100		95	190	4-Ø18		16		5.6	
907080040X0YY	40	180		150		110		105	230	4-Ø18		16	18	6.3	
907080050X0YY	50	200		165		125		115	240	4-Ø18		16	20	8.6	
907080065X0YY	65	220		185		145		145	280	4-Ø18	8-Ø18	18	22	12.7	
907080080X0YY	80	250		200		160		160	310	8-Ø18	8-Ø18	20	22	16.5	
907080100X0YY	100	280	220	235	180	190	185	185	330	8-Ø18	8-Ø23	20	24	21.6	25.6
907080125X0YY	125	320	250	270	210	220	215	600	800	8-Ø18	8-Ø25	22	28	32.8	41
907080150X0YY	150	360	285	300	240	250	245	800	800	8-Ø23	8-Ø25	24	30	43.6	54
907080200X0YY	200	400	340	360	295	310	300	1000	1000	12-Ø23	12-Ø25	26	34	65	86.5
907080250X0YY	250	450	405	425	355	370	380	1200	1200	12-Ø25	12-Ø30	30	36	97	138.5

X=1, PN=16
X=3, PN=25
YY=Different material

